

## PONSEN EN MATRIJZEN



# PONSEN EN MATRIJZEN TYPE PEDDINGHAUS



## PONSEN

### AFMETINGEN

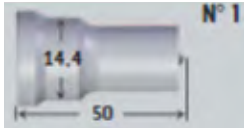

Ø 4-14  
(0,5mm)

5x10 - 5,5x10 - 5x14 - 5,5x14  
6x12 - 6,5x12 - 7x14

4 - 5 - 6 - 7 - 8 - 9 - 10

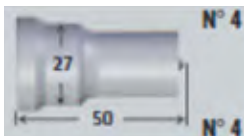

Ø 14,5 - 30  
(0,5mm)  
  
Ø 28 - 29 - 30  
Ø 30,3

5,5x19 - 5,5x25 - 6,5x18 - 6,5x26  
7,5x21 - 7,5x26 - 6,5x26  
8x16 - 9x18 - 9x26  
10x20 - 10x26 - 10x30 - 11x22  
11x26 - 12x24 - 13x26 - 14x26  
14x28 - 15x30 - 16x26 - 18x26

11 - 12 - 13 - 14 - 15  
16 - 17 - 18 - 19  
  
Ø 20 - 21

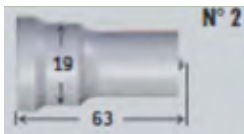

Ø 4 - 19  
(0,5mm)

5x10 - 5,5x10 - 5x14  
5,5x14 - 5,5x19  
6x12 - 6,5x18 -  
7x14 - 7,5x14  
8x16 - 9x18

4 - 5 - 6 - 7 - 8 - 9 - 10  
11 - 12 - 13

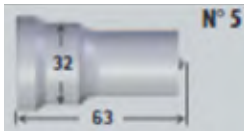

Ø 20 - 32mm  
(0,5mm)

5,5x25 - 6,5x26 - 7,5x26 - 9x26  
10x20 - 10x26 - 10x30 - 11x22  
11x26 - 11x30 - 12x24 - 12x30  
13x26 - 14x26 - 14x28 - 15x30  
16x26 - 16x31 - 18x26 - 18x31  
20x31 - 22x31

14 - 15 - 16 - 17 - 18 - 19 - 20  
- 21 - 22

## MATRIJZEN

### AFMETINGEN



Ø 4-30  
(0,5mm)  
  
speling 0,2 of 0,7

Idem Ponsen N°1 & N°4  
  
speling 0,2 of 0,7

Idem Ponsen N°1 & N°4  
  
speling 0,2 of 0,7

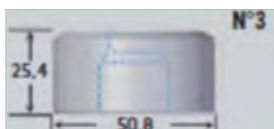

Ø 4-32  
(0,5mm)  
  
speling 0,2 of 0,7

Idem Ponsen N°2 & N°5  
  
speling 0,2 of 0,7

Idem Ponsen N°2 & N°5  
  
speling 0,2 of 0,7

# PONSEN TYPE GEKA

## PONSEN

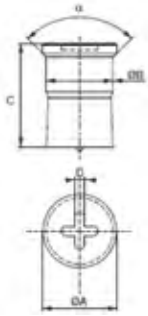

	A	B	C	D	
GN 5/27	30,50	27,00	52,00	4	60°
GN 5/30	31,50	30,00	52,00	4	60°
GN6	31,50	28,00	55,50	4	90°
GN8-19	24,00	19,00	62,00	-	90°
GN8-31	35,00	31,00	62,00	6	90°
GN8-31A	35,00	31,00	87,00	6	90°
GN8-40	43,50	40,00	62,00	6	60°

### TYPE



GN 5/27	Ø 4-27 (1/2mm)	5x10 - 7x14 - 9x18 - 11x22 - 13x26 - 16x26 - 6x12 - 8x16 - 10x20 - 12x24 - 14x26 - 18x26	Ø 4-19 (per mm)
GN 5/30	28° 29° 30°	20-21	Ø 30
GN 6	Ø 4-28 (1/2mm)	5x10 - 7x14 - 9x18 - 11x22 - 13x26 - 16x28 - 6x12 - 8x16 - 10x20 - 12x24 - 14x28 - 18x28	Ø 4-19 (per mm)
GN 8-19	Ø 4-19 (1/2mm)	-	-
GN 8-31	Ø 4-31 (1/2mm)	5x10 - 7x14 - 9x18 - 11x22 - 13x26 - 15x30 - 17x31 - 20x31 -6x12 - 8x16 - 10x20 - 12x24 - 14x28 - 16x31 - 18x31 - 22x31	Ø 4-21 (per mm)
GN 8-40	Ø 32-40 (per mm)	10x40 - 14x40 - 18x40 - 22x40 - 26x40 - 17x40 - 16x40 - 20x40 - 24x40 - 28x40	

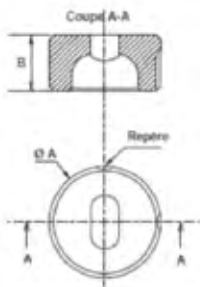

	A	B
GM5	50,8	25,4
GM8	60	32

### TYPE



GM 5	Ø 4-31 set 0,2 of 0,7	5x10 - 8x16 - 11x22 - 14x26 16x26 - 18x26 - 6x12 - 9x18 - 12x24 - 14x28 - 16x31 - 18x31 7x14 - 10x20 - 13x26 - 15x30 - 17x31 - 20x31	Ø 4-21 set 0,2 of 0,7
GM 8	Ø 32-40 set 0,2 of 0,7 maxi. 42,2	10x14 - 16x40 - 22x40 - 28x40 12x40 - 18x40 - 24x40 - 14x40 - 20x40 - 26x40	Ø 22-28 set 0,2 of 0,7

## PONSEN EN MATRIJZEN TYPE KINGSLAND



### PONSEN

#### AFMETINGEN



Ø 4-10  
(0,5mm)

5x10 - 6x12 - 7x14 -  
8x16 - 9x18

4 - 5 - 6 - 7 - 8 - 9 - 10



Ø 4-30  
(0,5mm)

6x12 - 7x14 -  
8x16 - 9x18 - 10x20 -  
11x22 - 12x24 - 13x26 -  
14x28 - 15x30

11 - 12 - 13 - 14 - 15  
16 - 17 - 18 - 19 - 20 - 21



Ø 31 - 38  
(0,5mm)

Alle maten  
Lengte max 38  
30-38

20-26

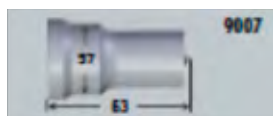

Ø 30 - 57  
(0,5mm)

Alle maten  
L max 57

27-40



Ø 5 - 30  
(0,5mm)

Alle maten  
L max 30,7  
idem p6

19-28



Ø 30 - 57  
(0,5mm)

Alle maten  
L max 57  
idem p7

27-40



Ø 50 - 85  
(0,5mm)

Alle maten  
L max 85

41-60

MATRIJZEN

AFMETINGEN



Ø 4-38  
(0,5mm)  
set 0,2-0,7

6x12 - 7x14 - 8x16 - 9x18 - 10x20  
11x22 - 12x24 - 13x26 - 14x28  
15x30  
set 0,2-0,7

4-26



Ø 30-57  
per mm  
set 0,2-0,7

Alle maten  
Lengte max 57

27-40



Ø 58 - 85  
per mm

Alle maten  
Lengte max 85

41-60



Ø 4-22  
(0,5mm)  
set 0,7



# PONSEN EN MATRIJZEN VOOR MUBEA OPNAME

## PONSEN EN MATRIJZEN VOOR MUBEA OPNAME



De werkelijke maat van de pons stemt overeen met de grootte van het te ponsen gat

De werkelijke maat van de matrijs is in eerste lijn afhankelijk van het te verwerken materiaal en wordt medegedeeld met de werkelijke maat van de pons plus speling (=2x snijspeling)

Normaal gezien bedraagt de snijspeling ongeveer 10% van de plaatdikte

### RONDE PONSEN



### RONDE MATRIJZEN

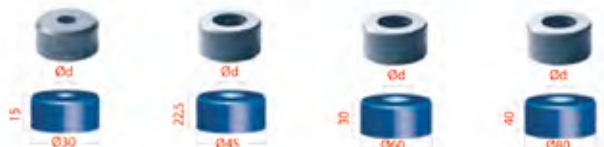

PONS MBP1-		PONS MBP2-		PONS MBP3-		PONS MBP4-	
3,0	9,5	14,0	22,5	30,5	41,0		
3,5	10,0	15,0	23,0	31,0	42,0		
4,0	10,5	15,5	23,5	32,0	43,0		
4,5	11,0	16,0	24,0	33,0	44,0		
5,0	11,5	16,5	24,5	34,0	45,0		
5,5	12,0	17,0	25,0	35,0	46,0		
6,0	12,5	17,5	25,5	36,0	47,0		
6,5	13,0	18,0	26,0	37,0	48,0		
7,0	13,5	18,5	26,5	38,0	49,0		
7,5	14,0	19,0	27,0	39,0	50,0		
8,0	14,5	19,5	27,5	40,0			
8,5	15,0	20,0	28,0				
9,0		20,5	28,5				
		21,0	29,0				
		21,5	29,5				
		22,0	30,0				

MATRIJS MBP1-		MATRIJS MBP1-		MATRIJS MBP1-		MATRIJS MBP1-	
3,2	9,7	14,7	24,2	32,2	37,7	42,7	47,2
3,7	10,2	15,2	24,7	32,7	38,2	43,2	47,7
4,2	10,7	15,7	25,2	33,2	38,7	43,7	48,2
4,7	11,2	16,2	25,7	33,7	39,2	44,2	48,7
5,2	11,7	16,7	26,2	34,2	39,7	44,7	49,2
5,7	12,2	17,2	26,7	34,7	40,2	45,2	49,7
6,2	12,7	17,7	27,2	35,2	40,7	45,7	50,2
6,7	13,2	18,2	27,7	35,7	41,2	46,2	50,7
7,2	13,7	18,7	28,2	36,2	41,7	46,7	51,2
7,7	14,2	19,2	28,7	36,7	42,2		
8,2	14,7	19,7	29,2	37,2			
8,7	15,2	20,2	29,7				
9,2	15,7	20,7	30,2				
		21,2	30,7				
		21,7	31,2				
		22,2	31,7				
		22,7	32,2				
		23,2	32,7				
		23,7					

**OVALE PONSEN**



**OVALE MATRIJZEN**



PONS MBOP2-		PONS MBOP3-	PONS MBOP4-	MATRIJS MBOM1-	MATRIJS MBOM2-		
5,0 x 10,0	10,5 x 15,0	9,0 x 40,0	11,0 x 45,0	5,3 x 10,3	5,3 x 20,3	9,8 x 30,3	14,0 x 21,0
5,0 x 15,0	10,5 x 21,0	11,0 x 35,0	11,0 x 50,0	5,3 x 15,3	5,8 x 20,3	10,0 x 19,0	14,0 x 26,0
5,0 x 20,0	10,5 x 25,0	11,0 x 40,0	13,5 x 50,0	5,8 x 11,3	6,0 x 21,0	10,0 x 21,0	14,0 x 31,0
5,0 x 25,0	10,5 x 30,0	13,5 x 35,0	17,5 x 50,0	5,8 x 15,3	6,5 x 21,0	10,0 x 26,0	14,3 x 20,3
5,5 x 11,0	11,0 x 20,0	13,5 x 40,0	20,5 x 50,0	6,0 x 11,0	6,8 x 20,3	10,0 x 31,0	14,3 x 25,3
5,5 x 15,0	11,0 x 25,0	14,0 x 35,0	22,5 x 50,0	6,0 x 16,0	6,8 x 30,3	10,5 x 21,0	14,3 x 30,3
5,5 x 20,0	11,0 x 30,0	14,0 x 40,0	24,0 x 50,0	6,5 x 12,0	7,3 x 25,3	10,5 x 26,0	14,5 x 21,0
5,5 x 25,0	12,0 x 20,0	16,0 x 35,0	25,5 x 50,0	6,5 x 16,0	7,5 x 21,0	10,5 x 31,0	14,5 x 26,0
6,5 x 13,0	12,0 x 25,0	16,0 x 40,0	26,0 x 50,0	6,8 x 13,3	7,5 x 31,0	10,8 x 21,3	14,5 x 31,0
6,5 x 20,0	12,0 x 30,0	17,5 x 35,0	27,0 x 50,0	7,3 x 15,3	8,0 x 26,0	10,8 x 25,3	15,0 x 21,0
6,5 x 25,0	13,0 x 20,0	17,5 x 40,0		7,5 x 14,0	8,3 x 20,3	10,8 x 30,3	15,0 x 26,0
6,5 x 30,0	13,0 x 25,0	19,0 x 35,0		8,0 x 16,0	8,3 x 30,3	11,3 x 20,3	15,0 x 31,0
7,0 x 15,0	13,0 x 30,0	19,0 x 40,0		8,3 x 13,3	9,0 x 26,0	11,3 x 25,3	16,3 x 25,3
7,0 x 20,0	13,5 x 20,0	20,5 x 35,0		9,0 x 14,0	9,3 x 18,3	11,3 x 30,3	16,3 x 30,3
7,0 x 25,0	13,5 x 25,0	20,5 x 40,0		9,3 x 13,3	9,3 x 25,3	11,5 x 22,0	17,0 x 26,0
7,0 x 30,0	13,5 x 30,0	22,5 x 35,0		10,0 x 14,0	9,8 x 20,3	11,5 x 26,0	17,0 x 31,0
8,0 x 13,0	14,0 x 20,0	22,5 x 40,0		10,8 x 15,3	9,8 x 25,3	11,5 x 31,0	17,8 x 25,3
8,0 x 20,0	14,0 x 25,0	24,0 x 40,0		11,5 x 16,0	5,3 x 25,3	12,0 x 21,0	17,8 x 30,3
8,0 x 25,0	14,0 x 30,0	25,5 x 40,0			5,8 x 25,3	12,0 x 26,0	18,5 x 26,0
8,0 x 30,0	16,0 x 25,0	26,0 x 40,0			6,0 x 26,0	12,0 x 31,0	18,5 x 31,0
9,0 x 13,0	16,0 x 30,0	27,0 x 40,0			6,5 x 26,0	12,3 x 20,3	19,3 x 25,3
9,0 x 18,0	17,5 x 25,0				6,8 x 25,3	12,3 x 25,3	19,3 x 30,3
9,0 x 20,0	17,5 x 30,0				7,3 x 20,3	12,3 x 30,3	20,0 x 26,0
9,0 x 25,0	19,0 x 25,0				7,3 x 30,3	13,0 x 21,0	20,0 x 31,0
9,0 x 30,0	19,0 x 30,0				7,5 x 26,0	13,0 x 26,0	20,8 x 30,3
9,5 x 20,0	20,5 x 30,0				8,0 x 21,0	13,0 x 31,0	21,5 x 31,0
9,5 x 25,0	22,5 x 30,0				8,0 x 31,0	13,3 x 20,3	22,8 x 30,3
9,5 x 30,0	25,5 x 30,0				8,3 x 25,3	13,3 x 25,3	23,5 x 31,0
					9,0 x 21,0	13,3 x 30,3	25,8 x 30,3
					9,0 x 31,0	13,8 x 20,3	26,5 x 31,0
					9,3 x 20,3	13,8 x 25,3	
					9,3 x 30,3	13,8 x 30,3	
					9,8 x 20,3	13,3 x 25,3	
					9,8 x 25,3	13,3 x 30,3	
						13,8 x 20,3	
						13,8 x 25,3	
						13,8 x 30,3	

**OVALE MATRIJS**



**MATRIJS  
MBOM3-**

9,3 x 40,3	19,3 x 35,3
10,0 x 41,0	19,3 x 40,3
11,3 x 40,3	20,0 x 36,0
13,8 x 35,3	20,0 x 41,0
13,8 x 40,3	20,8 x 35,3
14,3 x 35,3	20,8 x 40,3
14,3 x 40,3	21,5 x 36,0
14,5 x 36,0	21,5 x 41,0
14,5 x 41,0	22,8 x 35,3
15,0 x 36,0	22,8 x 40,3
15,0 x 41,0	23,5 x 36,0
16,3 x 35,3	23,5 x 41,0
16,3 x 40,3	24,3 x 40,3
17,0 x 36,0	25,0 x 41,0
17,0 x 41,0	26,3 x 40,3
17,8 x 35,3	26,5 x 41,0
17,8 x 40,3	27,0 x 41,0
18,5 x 36,0	27,3 x 40,3
18,5 x 41,0	

**MATRIJS  
MBOM4-**

11,3 x 45,3
11,3 x 50,3
12,0 x 46,0
12,0 x 51,0
13,8 x 50,3
14,5 x 51,0
17,8 x 50,3
18,5 x 51,0
20,8 x 50,3
21,5 x 51,0
22,8 x 50,3
23,5 x 51,0
24,3 x 50,3
25,0 x 51,0
25,8 x 50,3
26,3 x 50,3
26,5 x 51,0
27,0 x 51,0
27,3 x 50,3
28,0 x 51,0

**VIERKANTE PONS**



**PONS  
MBPV2-**

4,0
5,0
6,0
7,0
8,0
9,0
10,0
11,0
12,0
13,0
14,0
15,0
16,0
17,0
18,0
19,0
20,0

**PONS  
MBPV3-**

21,0
22,0
23,0
23,5
24,0
24,5
25,0
25,5
26,0
26,5
27,0
27,5
28,0

**PONS  
MBPV4-**

28,5
29,0
29,5
30,0
30,5
31,0
31,5
32,0
32,5
33,0
33,5
34,0
34,5
35,0



## PONSEN EN MATRIJZEN VOOR DRAAGBARE MACHINES

### NITTO-ALFRA-MAGTRON



#### AFMETINGEN

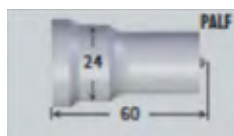

Ø 8-24

8x16 - 9x18 - 10x20  
11x22 - 12x24 - 13x24  
14x24 - 16x24  
18x24 - 20x24

Ø 25



Ø 8-24  
set 1mm

8x16 - 9x18 - 10x20  
11x22 - 12x24 - 13x24  
14x24 - 16x24  
18x24 - 20x24

Ø 25

set 1mm

## PONSEN EN MATRIJZEN VOOR DRAAGBARE MACHINES



### PROMOTECH – FE POWERTOOLS



Ø	RONDE PONS	RONDE MATRIJS
7	STM-0507-20-18-00-0	MTY-0507-40-18-00-0
8	STM-0507-20-17-00-0	MTY-0507-40-17-00-0
9	STM-0507-20-16-00-0	MTY-0507-40-16-00-0
10	STM-0507-20-15-00-0	MTY-0507-40-15-00-0
11	STM-0507-20-14-00-0	MTY-0507-40-14-00-0
12	STM-0507-20-13-00-0	MTY-0507-40-13-00-0
13	STM-0507-20-12-00-0	MTY-0507-40-12-00-0
14	STM-0507-20-11-00-0	MTY-0507-40-11-00-0
15	STM-0507-20-10-00-0	MTY-0507-40-10-00-0
16	STM-0507-20-09-00-0	MTY-0507-40-09-00-0
17	STM-0507-20-08-00-0	MTY-0507-40-08-00-0
18	STM-0507-20-07-00-0	MTY-0507-40-07-00-0
19	STM-0507-20-06-00-0	MTY-0507-40-06-00-0
20	STM-0507-20-05-00-0	MTY-0507-40-05-00-0
21	STM-0507-20-04-00-0	MTY-0507-40-04-00-0
22	STM-0507-20-03-00-0	MTY-0507-40-03-00-0
23	STM-0507-20-02-00-0	MTY-0507-40-02-00-0
24	STM-0507-20-01-00-0	MTY-0507-40-01-00-0
25	STM-0507-20-00-00-0	MTY-0507-40-00-00-0
26	STM-0507-20-19-00-0	MTY-0507-40-19-00-0
27	STM-0507-20-20-00-0	MTY-0507-40-20-00-0

Ø	SLEUF PONS	SLEUF MATRIJS
16x8	STM-0507-30-13-00-0	MTY-0507-70-13-00-0
18x9	STM-0507-30-12-00-0	MTY-0507-70-12-00-0
18x11	STM-0507-30-11-00-0	MTY-0507-70-11-00-0
20x10	STM-0507-30-10-00-0	MTY-0507-70-10-00-0
20x12	STM-0507-30-09-00-0	MTY-0507-70-09-00-0
20x14	STM-0507-30-08-00-0	MTY-0507-70-08-00-0
22x11	STM-0507-30-07-00-0	MTY-0507-70-07-00-0
22x14	STM-0507-30-06-00-0	MTY-0507-70-06-00-0
24x12	STM-0507-30-05-00-0	MTY-0507-70-05-00-0
25x9	STM-0507-30-04-00-0	MTY-0507-70-04-00-0
25x12	STM-0507-30-03-00-0	MTY-0507-70-03-00-0
25x13	STM-0507-30-02-00-0	MTY-0507-70-02-00-0
25x14	STM-0507-30-01-00-0	MTY-0507-70-01-00-0
25x18	STM-0507-30-00-00-0	MTY-0507-70-00-00-0