

nÂ°	Artikel	Aantal gebruikt
	STANDARD ACCESSORIES	0
	OPTIONAL ACCESSORIES	0
1	306345 FRONT CAP	1
2	306340 STOPPER RING	1
3	324527 GRIP	1
4	330192 BALL HOLDER	1
5	324526 HOLDER PLATE (OLD 322811)	1
6	330191 HOLDER SPRING	1
7	992803 SEAL LOCK HEX. SOCKET HD. BOLT M6X20 (OLD 986086)	4
8	330174 CYLINDER CASE	1
9A	334370 O-RING (I.D 49.5)	1
10	328867 OIL SEAL	1
11	330175 DAMPER (A)	1
12	330184 DAMPER WASHER (B)	1
13	304020 FELT PACKING (A)	1
14	6905DD BALL BEARING 6905DDUCMNS7S	1
15	330176 WASHER (A)	1
16	330177 LOCK SPRING	1
17	330178 LOCK SLEEVE	1
18	330179 WASHER (B)	1
19	330187 SLIDE SLEEVE	1
20	959156 STEEL BALL D7.0 (10 PCS)	1
21	330180 CYLINDER	1
22	323058 O-RING (C)	1
23	330181 SECOND HAMMER	1
24	330182 DAMPER WASHER	1
25	330183 DAMPER (B)	1
26	331672 DAMPER HOLDER (A)	1
27	330186 O-RING (A)	1
28	331673 DAMPER HOLDER (B)	1
29	323062 STOPPER RING	1
30	330185 STRIKER	1
32	330188 CLUTCH SPRING	1
33	330189 CLUTCH	1
34	330190 BEVEL GEAR	1
35	319577 O-RING (I.D.19.2)	1
36A	330173 PISTON PIN	1
37	330172 PISTON	1

nÂ°	Artikel	Aantal gebruikt
38	319585 CONNECTING ROD	1
39	330236 NOZZLE (C)	1
40	330237 NOZZLE SEAL	1
41	330235 NOZZLE (B)	1
43	330234 NOZZLE (A)	1
44	330231 FELT WASHER	1
45	330229 INNER PIPE (A)	1
46A	DOUBLE FACE TAPE(AVAILABIE AT STORES)	1
47	330230 INNER PIPE (B)	1
48	330221 DUST CASING (A)	1
49	330233 OUTER PIPE	1
50	330232 PIPE SPRING	1
51	330242 ADJUSTING ROD	1
52	330246 STOPPER	1
53	330243 ADJUSTER (A)	2
54	330245 SPRING	2
55	330244 ADJUSTER (C)	2
56	330223 LEAF SPRING	1
57	330224 LEVER	1
58	330225 PIN D3	1
59	330226 SEAL PLATE (A)	1
60	330227 SEAL PACKING (A)	1
61	330228 DUST BOX	1
63	983162 SEAL LOCK HEX. SOCKET HD. BOLT M4X12	1
64A	331545 CHANGE LEVER (OLD 321309)	1
65	330207 LEVER HOLDER	1
66	939556 RETAINING RING FOR D35 HOLE (10 PCS)	1
67	330206 LEVER SHAFT	1
68	330205 O-RING	1
69A	331548 PIN D2X10	1
70A	331546 LEVER SPRING	1
71	321311 PUSHING BUTTON	1
73	330249 DUST WASHER	1
74	330250 CASING	1
75	330248 FAN GUIDE (B)	1
76	360859G ARMATURE 127V	1
76	360859U ARMATURE ASS'Y 120V	1
76	360859C ARMATURE 110-115 VOLT	1

nÂ°	Artikel	Aantal gebruikt
76	360859F ARMATURE 240V	1
76	360859E	1
77	330247 FAN GUIDE (A)	1
78	982631 WASHER (A)	1
80	980864 @ HEX.HD. TAPPING SCREW D5X40	2
81	340739C STATOR 110-115 VOLT	1
81	340739H STATOR 220V-230V	1
81	340739E STATOR 220-230 VOLT	1
81	340739K STATOR 127V	1
81	340739J STATOR 240V	1
81	340739G STATOR 120V	1
82	330201 HOUSING ASS'Y	1
83	935829 BRUSH CAP	2
84A	999004 CARBON BRUSH (1 PAIR)	2
85	957051 BRUSH HOLDER	2
86	302089 TAPPING SCREW (W/FLANGE) D5X20 (BLACK)	2
87	938477 HEX.SOCKET SET SCREW M5X8	2
88	330203 TAIL COVER	1
89	307811 TAPPING SCREW D4X16 (W/FLANGE) (BLACK) (OLD 930446)	6
90	331727 DAMPER (B)	1
91	310111 BEARING BUSH (B)	1
92	331729 TOP COVER	1
93	994192 HEX.SOCKET HD.BOLT	6
94	330251 SEAL LOCK BOLT M5X55	4
95A	330196 BEVEL PINION	1
96	330197 COLLAR	1
97	6001DD BALL BEARING 6001DDUCMPS2S (OLD 980925)	1
98	939542 RETAINING RING FOR D12 (10 PCS)	1
99	992503 WASHER	3
100	330198 SECOND GEAR	1
101	959155 STEEL BALL D3.97 (10 PCS.)	8
102	992916 CLUTCH PLATE	1
103	992926 SPRING PLATE	2
104	980877 BELLEVILLE SPRING	2
105	330199 BUSHING	1
106	608VVM BALL BEARING 608VVC2PS2L	1
107	330204 CRANK COVER	1
108	324544 FELT PACKING (B)	1

nÂ°	Artikel	Aantal gebruikt
109	331674 FELT PACKING	1
110	331675 RUBBER SEAL	1
111	330169 CRANK CASE	1
112	331676 SEAL PACKING	1
113	981851 OIL SEAL (B)	2
114	330194 SLEEVE	1
115A	330170 CRANK SHAFT	1
116	944109 FEATHER KEY 3X3X8	1
117	6002DD BALL BEARING 6002DDUCMPS2S	1
118A	334369 O-RING (I.D 31.5)	1
119	948001 RETAINING RING D32 HOLE	1
120A	330171 FIRST GEAR	1
121	330200 GEAR COVER	1
122	NAME PLATE	1
123	886342 HITACHI PLATE	2
124	330257 HANDLE (A+B) SET	1
125	322853 PUSHING BUTTON	1
126	316228 HEX.SOCKET HD BOLT (W/FLANGE)M4X10	4
127	307028 TAPPING SCREW (W/FLANGE) D4X25 (BLACK)	3
128	330240	1
129	330239	2
130	330222 DUST CASING (B)	1
131	330241	1
132	317492 SUPPORT (B)	1
133	930039 NOISE SUPPRESSOR	1
134	330254 INTERNAL WIRE BLUE 18AWGX300L	1
134	330217 INTERNAL WIRE BLUE 16AWGX300L	1
135	330218 INTERNAL WIRE BROWN 16AWGX300L	1
135	330255 INTERNAL WIRE BROWN 18AWGX300L	1
136	331677 SWITCH	1
136A	334371 SWITCH (1P PILLAR TYPE) (OLD 330214)	1
137	984750 TAPPING SCREW (W/FLANGE) D4X16	2
138	960266 CORD CLIP	1
139	953327 CORD ARMOR D8.8	1
140	321322 VINYL TUBE	1
141A	500432Z CORD	1
141	500465Z CORD 4M 2 X 1.0 H07RN-F W/PLUG 16A CEE FORM 2P+E 110 VOLT	1
141	500390Z CORD 5M 2 X 1.5 FOR HOL (NEW 714520)	1

nÂ°	Artikel	Aantal gebruikt
141	500446Z CORD FOR GBR 230V	1
141	500424Z @ CORD FOR SINZ KUW	1
142	330195 SLIP CLUTCH ASS'Y	1
501	330220 CASE	1
502	330208 SIDE HANDLE ASS'Y	1
503	330209 SIDE HANDLE	1
504	307947 WING BOLT M6X12	1
505	330210 MOUNT	1
506	949556 NUT M6 (10 PCS)	1
507	330212 BAND	1
508	330211 BOLT HOLDER	1
509	330213 BOLT M8X45	1
510	982671 STOPPER ROD	1
511	330238 RUBBER CAP	1
512	331730 SUCTION COVER (OLD 330253)	1
601	303046 BULL POINT (SDS+) 250MM(ROUND SHANK TYPE	1
602	303044 CHEMICAL ANCHOR ADAPTER (SDS+)12.7MMX90L	1
603	303045 CHEMICAL ANCHOR ADAPTER(SDS+)19.0MMX100L	1
604	303334 CHUCK HANDLE	1
605	302976 ANCHOR SETTING ADAPTER A (SDS+)W1/4X260L	1
606	930515 CHUCK WRENCH 10G	1
607	302975 ANCHOR SETTING ADAPTER A(SDS+)W5/16X260L	1
608	303621 ANCHOR SETTING ADAPTER A (SDS+)W3/8X160L	1
609	302974 ANCHOR SETTING ADAPTER A (SDS+)W3/8X260L	1
610	302979 ANCHOR SETTING ADAPTER B (SDS+)W1/4X260L	1
611	302978 ANCHOR SETTING ADAPTER B(SDS+)W5/16X260L	1
612	303622 ANCHOR SETTING ADAPTER B (SDS+)W3/8X160L	1
613	302977 ANCHOR SETTING ADAPTER B (SDS+)W3/8X260L	1
614	303617 TAPER SHANK ADAPTER (SDS PLUS) NO.1	1
615	303618 TAPER SHANK ADAPTER (SDS PLUS) NO.2	1
616	303619 A-TAPER SHANK ADAPTER (SDS PLUS)	1
617	303620 B-TAPER SHANK ADAPTER (SDS PLUS)	1
618	981122 SPECIAL SCREW M6X22	1
619	303627 CORE BIT SHANK (SDS PLUS) 45-90MM 300L	1
620	303625 CORE BIT SHANK (SDS PLUS) 25-38MM 105L	1
621	303626 CORE BIT SHANK (SDS PLUS) 25-38MM 300L	1
622	303624 CHUCK ADAPTER (D) (SDS PLUS)	1
623	321825 DRILL CHUCK AND ADAPTER SET	1

nÂ°	Artikel	Aantal gebruikt
624	303623 CHUCK ADAPTER (G) (SDS PLUS)	1
625	321814 DRILL CHUCK 13VLRB-D	1
626	995344 FLAT HD.SCREW M6X25 (A) (LEFT HAND) (NEW 744087)	1
627	321813 DRILL CHUCK 13VLD-D	1
628	980927 GREASE FOR IMPACT DRILL (FG-6A) (500G)	1
629	981840 GREASE (FG-6A) (30G)	1
630	308471 GREASE FOR HAMMER DRILL (70G)	1
631	971511Z BIT NO.2.25L (NEW 751151)	1
632	971512Z + DRIVER BIT (A) NO.3 25L	1
633	944477 COTTER	1
634	982684 CENTER PIN (A) 109L FOR CORE BIT D32-38	1
635	982685 CENTER PIN (B) 104L FOR CORE BIT D45-90	1
636	315921 ADAPTER (A) FOR HAMMER DRILL	1
637	982672 CORE BIT (A) 25MM	1
638	982673 CORE BIT (A) 29MM	1
639	982674 CORE BIT (A) 32MM	1
640	982686 GUIDE PLATE (FOR CORE BIT 32MM)	1
641	982675 CORE BIT (A) 35MM	1
642	982687 GUIDE PLATE FOR CORE BIT 35MM (DISCON)	1
643	982676 CORE BIT (A) 38MM	1
644	982688 GUIDE PLATE (FOR CORE BIT 38MM)	1
645	982677 CORE BIT (B) 45MM	1
646	982689 GUIDE PLATE (FOR CORE BIT 45MM)	1
647	982678 CORE BIT (B) 50MM	1
648	982690 GUIDE PLATE (FOR CORE BIT 50MM)	1
649	982679 CORE BIT (B) 65MM	1
650	982691 GUIDE PLATE (FOR CORE BIT 65MM)	1
651	982680 CORE BIT (B) 80MM	1
652	982692 GUIDE PLATE (FOR CORE BIT 80MM)	1
653	971794 ANCHOR SETTING ADAPTER A W1/4" (MANUAL)	1
654	971795 ANCHOR SETTING ADAPTER A W5/16" (MANUAL)	1
655	971796 ANCHOR SETTING ADAPTER A W3/8" (MANUAL)	1
656	971797 ANCHOR SETTING ADAPTER A W1/2" (MANUAL)	1
657	971798 ANCHOR SETTING ADAPTER A W5/8" (MANUAL)	1
658	971799 ANCHOR SETTING ADAPTER B W1/4" (MANUAL)	1
659	971800 ANCHOR SETTING ADAPTER B W5/16" (MANUAL)	1
660	971801 ANCHOR SETTING ADAPTER B W3/8" (MANUAL)	1
661	971802 ANCHOR SETTING ADAPTER B W1/2" (MANUAL)	1

nÂ°	Artikel	Aantal gebruikt
662	971803 ANCHOR SETTING ADAPTER B W5/8" (MANUAL)	1
663	944460 TAPER SHANK DRILL BIT D11X100	1
664	944461 TAPER SHANK DRILL BIT D12.3X110	1
665	993038 TAPER SHANK DRILL BIT D12.7X110	1
667	944500 TAPER SHANK DRILL BIT D14.5X110	1
669	944464 TAPER SHANK DRILL BIT D21.5X140	1
670	320859 SYRINGE (BLOW-OUT BULB TYPE)	1
671	303571 DRILL BIT (SDS PLUS) D4.0X110	1
672	303575 DRILL BIT (SDS PLUS) D5.0X110	1
673	303578 DRILL BIT (SDS PLUS) D5.0X160	1
674	303576 DRILL BIT (SDS PLUS) D5.5X110	1
675	303581 DRILL BIT (SDS PLUS) D6.5X160	1
676	303582 DRILL BIT (SDS PLUS) D7.0X160	1
677	303584 DRILL BIT (SDS PLUS) D8.0X160	1
678	303585 DRILL BIT (SDS PLUS) D8.5X160	1
679	303586 DRILL BIT (SDS PLUS) D9.0X160	1
680	303591 DRILL BIT (SDS PLUS) D12.0X160	1
681	303606 DRILL BIT (SDS PLUS) D12.0X260	1
682	303593 DRILL BIT (SDS PLUS) D12.7X160	1
683	303595 DRILL BIT (SDS PLUS) D14.0X160	1
684	303598 DRILL BIT (SDS PLUS) D15.0X160	1
685	303599 DRILL BIT (SDS PLUS) D16.0X160	1
686	303611 DRILL BIT (SDS PLUS) D16.0X260	1
687	303601 DRILL BIT (SDS PLUS) D17.0X160	1
688	303613 DRILL BIT (SDS PLUS) D19.0X260	1
689	303614 DRILL BIT (SDS PLUS) D20.0X260	1
690	303615 DRILL BIT (SDS PLUS) D22.0X260	1
691	303616 DRILL BIT (SDS PLUS) D25.0X450	1
692	971787 DUST CUP	1
693	318085 SYRINGE (BELLOWS TYPE)	1
694	306885 DUST COLLECTOR (B) ASS'Y	1
695	986802 DUST COLLECTOR ASS'Y	1
696	986803 @ DUST COVER	1
697	986804 @ SEAL COVER NEW	1
698	948310 RETAINING RING FOR D30 SHAFT	1
699	958063 @ WASHER (OLD 958063P)	1
700	959150 STEEL BALL D6.35 (10 PCS.)	1
701	986805 @ OUTER RACE NEW	1

nÂ°	Artikel	Aantal gebruikt
702	986806 SOCKET	1
703	306910 SOCKET ADAPTOR (B)	1



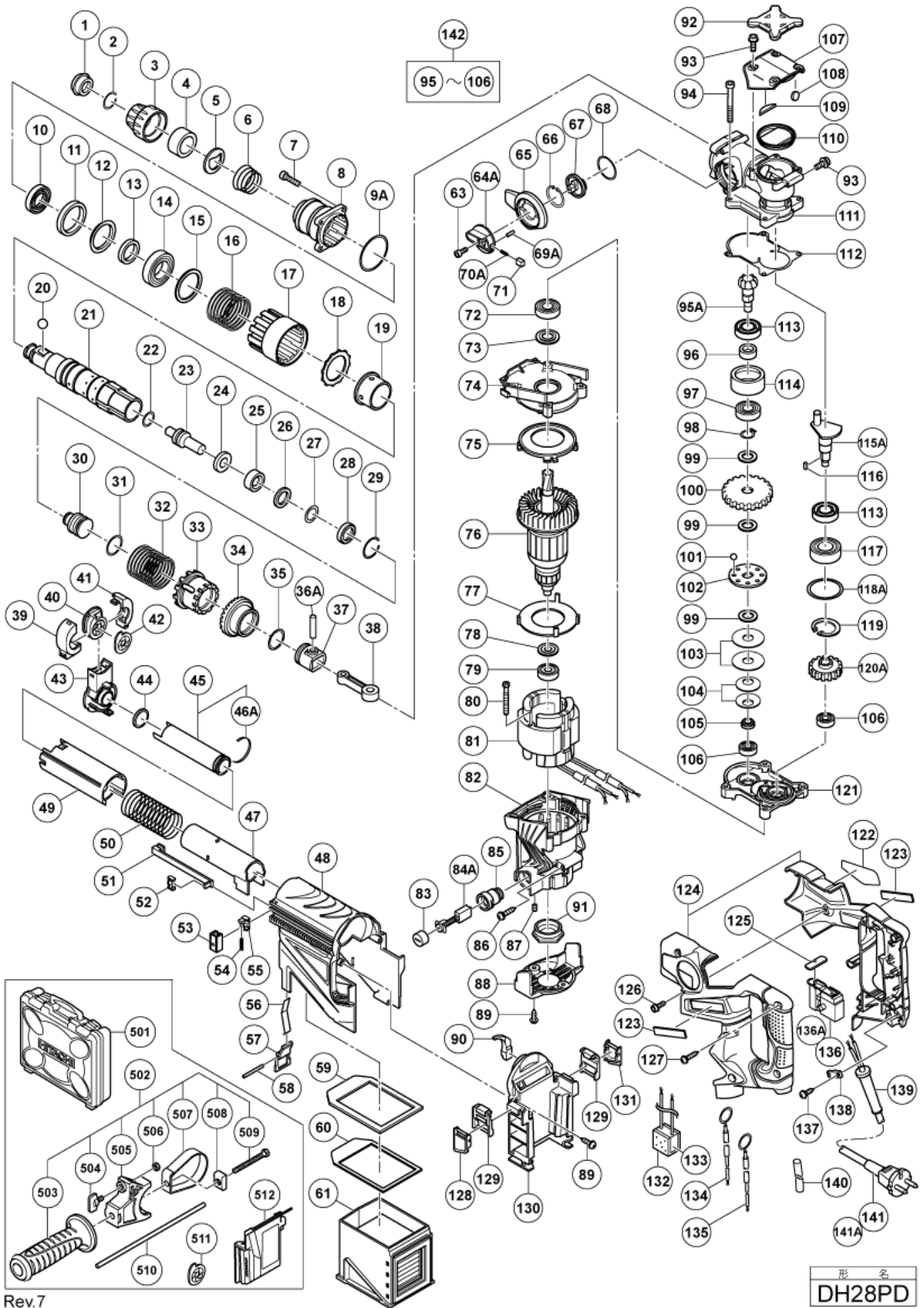

Rev.7